



# Sewage System Permit to Install

File No. 20140408  
Roll No. 1651 210 06007602

Owner: RAWDY PUDDISTER Date: JUNE 4, 2014  
Lot #: PT. 24 Concession: 11 Plan: 57R1494 Sublot/Part: N/A  
Civic Address: 33 NORTHLINE RD.

Test Pit Soil Conditions	
Depth	Soil Type
0	TOPSOIL 1'
1.5	SILT CLAY WITH TRACE SANDS

### 1. Assessment of Property

- a. Surface Drainage:  Good  Fair  Poor
- b. Slope of Ground:  Level  Gradual  Steep
- c. Clearances:  Satisfactory  Unsatisfactory
- d. Percolation Rate (Native): 40-45 min/cm  Estimated  Measured
- e. Percolation Rate (Fill): \_\_\_\_\_ min/cm

### 2. Decision: On the basis of your application the property is:

- Acceptable if the system is installed as outlined in items 3-6 and as per the design submitted.

### 3. Approved Work to be completed:

- a. Type of Sewage Disposal System:  Class 2 or 3  Class 4  Class 5
- b. Description of Work:  New  Repair/Alteration  Tank Replacement  Bed Replacement

### 4. Approved Design of the Sewage System includes:

- Class 2 or 3 System: Size: \_\_\_\_\_ m<sup>2</sup> Configured As: Length \_\_\_\_\_ m x Width \_\_\_\_\_ m x Height \_\_\_\_\_ m
- Class 5 System: Holding Tank: \_\_\_\_\_ L
- Class 4 System: Septic Tank: 4500 L Alternative System: \_\_\_\_\_
  - Conventional Trench: \_\_\_\_\_ m
  - Filter Bed Area: 28 m<sup>2</sup> Expanded Contact Area: 111 m<sup>2</sup>
  - Type A Dispersal Bed/BMEC Area Bed: Stone Area: \_\_\_\_\_ m<sup>2</sup> Sand Area: \_\_\_\_\_ m<sup>2</sup>
  - Type B Dispersal Bed: Dispersal Bed Area: \_\_\_\_\_ m<sup>2</sup> Configured As: \_\_\_\_\_ m x \_\_\_\_\_ m
  - Loading Rate Area: 350 m  Imported  Native  15 metre Mantle  Constructed  Native  Not Applicable
  - Height Raised Above Original Grade: 0.6-0.9 m

### 5. Sewage System Design is based on:

- a. Total Daily Sewage Flow: 2100 L/day
- No. of Bedrooms: 4; Total No. of Fixture Units 22; Total Living Space 167 m<sup>2</sup>
- Commercial: \_\_\_\_\_

### 6. Comments

- Ensure compliance with Part 8 of the Ontario Building Code O. Reg. 332/12 as amended.
- Sewage System is to be installed by GRIFFIN CONSTRUCTION and as per the design of MARK GRIFFEN dated, MAY 21, 2014
- Aggregate Sheet/Filter Sand Invoice to be submitted prior to issuance of an Installation Permit.
- "As Built" Designs, or Engineer sign-off and a Maintenance Agreement to be provided prior to issuance of an Installation Permit.
- Audible/ Visual Alarm and a Sewage Haulage Agreement to be submitted prior to issuance of an Installation Permit.
- Sewage System is not designed to receive backwash water from a water treatment device (water softener, etc).
- Other: \_\_\_\_\_

**Written Authorization must be obtained for any DEVIATION from the above APPROVAL prior to INSTALLATION**

This permit is issued under the Building Code Act and Ontario Regulation 332/12 as amended for the proposal outlined in the corresponding application and design submitted.

Inspected and Issued By: A. Chinski Date: JUNE 4, 2014

Note: Upon commencement of the installation, it is the responsibility of the owner/applicant to arrange for the necessary inspections prior to backfilling in order that a Sewage System Installation Permit may be issued.

### Proposed Design Site Plan

Indicate North Point and show the following required information:

- |                                      |                            |                                                           |
|--------------------------------------|----------------------------|-----------------------------------------------------------|
| 1. Septic Tank and Leaching Bed      | 7. Existing Sewage Systems | 13. Topographical Features<br>(steep slopes, swamps etc.) |
| 2. Pump Chamber                      | 8. Driveways               | 14. Direction of Slope                                    |
| 3. Loading Rate Area                 | 9. Surface Waters          | 15. Direction of Surface and<br>Ground Water Flow         |
| 4. 15 metre Mantle Area              | 10. Property Lines         |                                                           |
| 5. Proposed Structures               | 11. Foundation Drain       |                                                           |
| 6. Water Supplies (incl. neighbours) | 12. Eavestrough Discharge  |                                                           |

Note: The loading rate area and the 15 metre mantle area are to be free of structures.

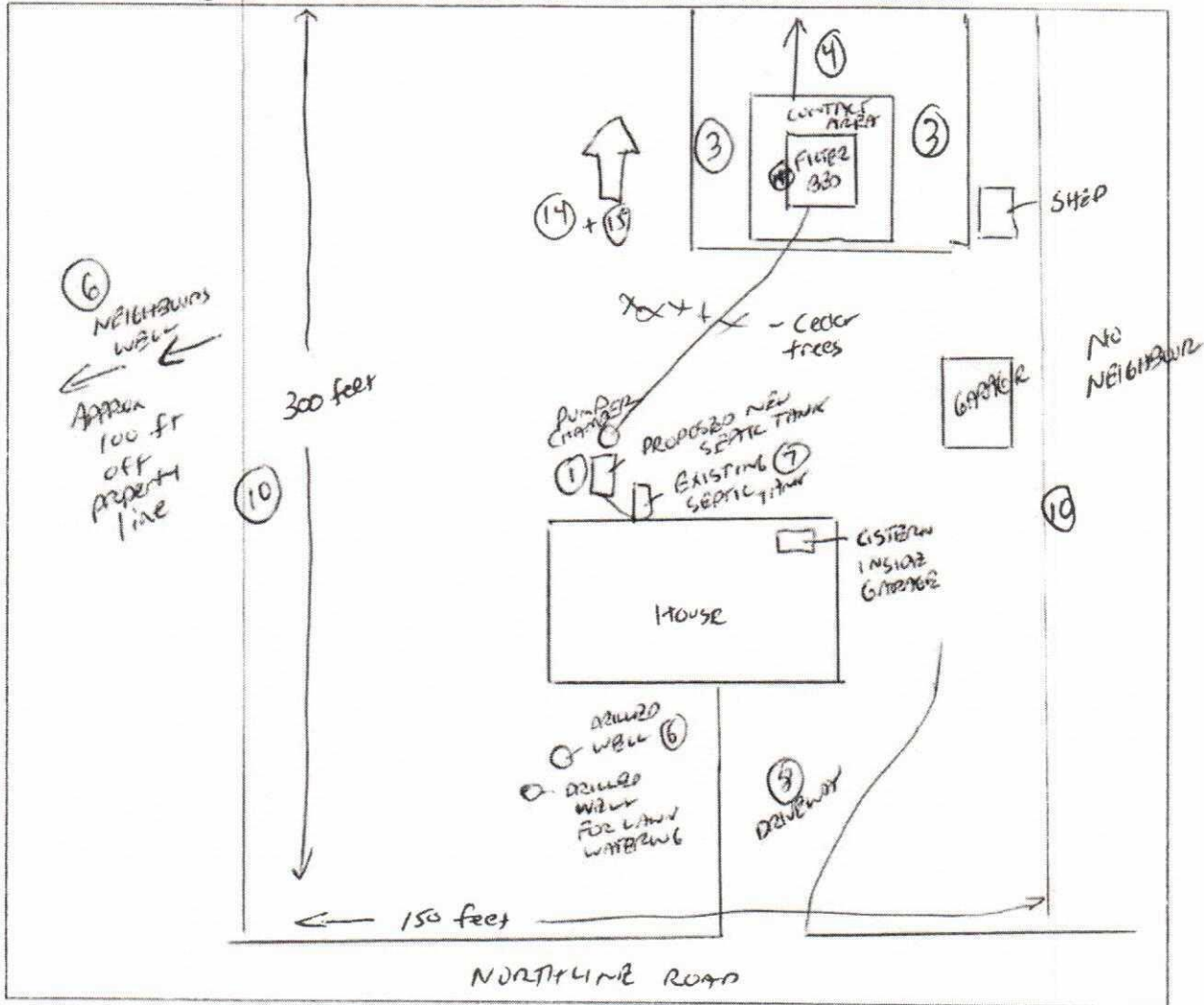

MARK GRIFFIN      Mark Griffin      MAY 21, 2014  
 Owner/Installer/Designer Name      Signature      Date

\* Same person who filled out "B" on schedule 1 of OBC Application Form.

**Office Use Only**

Approved:    Yes    No    File # \_\_\_\_\_

Reviewed By: \_\_\_\_\_

Sewage System Inspector's Name      Signature      Date