



Ontario

MINISTRY OF THE ENVIRONMENT
The Ontario Water Resources Act

WATER WELL RECORD

31D10E

1. PRINT ONLY IN SPACES PROVIDED
2. CHECK CORRECT BOX WHERE APPLICABLE

11 6407434

MUNICIPALITY 64007 CON. CAN

11

COUNTY OR DISTRICT: West TOWNSHIP, BOROUGH, CITY, TOWN, VILLAGE: Fenelon CON., BLOCK, TRACT, SURVEY, ETC.: 11 AR LOT: 25-27

DATE COMPLETED: DAY 31 MO 12 YR 77

ADDRESS: Box 755 Fenelon

ELEVATION: 134700 ELECTRIC CODE: 5 TELEPHONE CODE: 0905 MAIL CODE: 6 24

LOG OF OVERBURDEN AND BEDROCK MATERIALS (SEE INSTRUCTIONS)

| GENERAL COLOUR | MOST COMMON MATERIAL | OTHER MATERIALS | GENERAL DESCRIPTION | DEPTH - FEET | |
|----------------|----------------------|-----------------|---------------------|--------------|----|
| | | | | FROM | TO |
| | Top Soil | | | 0 | 2 |
| | Clay Gravel | | | 2 | 12 |
| | Light Sand | | | 12 | 55 |

31 0002 02 0012 05/11 0055 15

32

41 WATER RECORD

WATER FOUND AT - FEET: 0040

KIND OF WATER:

10-13: FRESH SALTY SULPHUR MINERAL

15-18: FRESH SALTY SULPHUR MINERAL

20-23: FRESH SALTY SULPHUR MINERAL

25-28: FRESH SALTY SULPHUR MINERAL

30-33: FRESH SALTY SULPHUR MINERAL

51 CASING & OPEN HOLE RECORD

| INSIDE DIAMETER INCHES | MATERIAL | WALL THICKNESS INCHES | DEPTH - FEET | |
|------------------------|--|-----------------------|--------------|-------------|
| | | | FROM | TO |
| <u>06 1/2</u> | <input checked="" type="checkbox"/> STEEL | <u>188</u> | <u>0</u> | <u>0012</u> |
| <u>06</u> | <input checked="" type="checkbox"/> GALVANIZED | | <u>12</u> | <u>0055</u> |

SCREEN

SIZE(S) OF OPENING (SLOT NO.): 31-33 DIAMETER: 34-38 LENGTH: 39-40

MATERIAL AND TYPE: _____ DEPTH TO TOP OF SCREEN: _____

61 PLUGGING & SEALING RECORD

| DEPTH SET AT - FEET | MATERIAL AND TYPE | CEMENT GROUT LEAD PACKER, ETC. |
|-------------------------------------|-------------------|--------------------------------|
| FROM: <u>10-13</u> TO: <u>14-17</u> | | |
| FROM: <u>18-21</u> TO: <u>22-25</u> | | |
| FROM: <u>28-29</u> TO: <u>30-33</u> | | |

71 PUMPING TEST

PUMPING TEST METHOD: PUMP BAILER

PUMPING RATE: 0001 GPM

DURATION OF PUMPING: 02 HOURS 00 MINS

WATER LEVELS DURING:

| STATIC LEVEL | WATER LEVEL END OF PUMPING | 15 MINUTES | 30 MINUTES | 45 MINUTES | 60 MINUTES |
|-----------------|----------------------------|-----------------|------------|------------|------------|
| <u>010</u> FEET | <u>055</u> FEET | <u>010</u> FEET | | | |

IF FLOWING GIVE RATE: _____ PUMP INTAKE SET AT: 52 FEET

WATER AT END OF TEST: CLEAR CLOUDY

RECOMMENDED PUMP TYPE: SHALLOW DEEP

RECOMMENDED PUMP SETTING: _____ FEET

RECOMMENDED PUMPING RATE: 0001 GPM

50-53 _____ GPM./FT. SPECIFIC CAPACITY

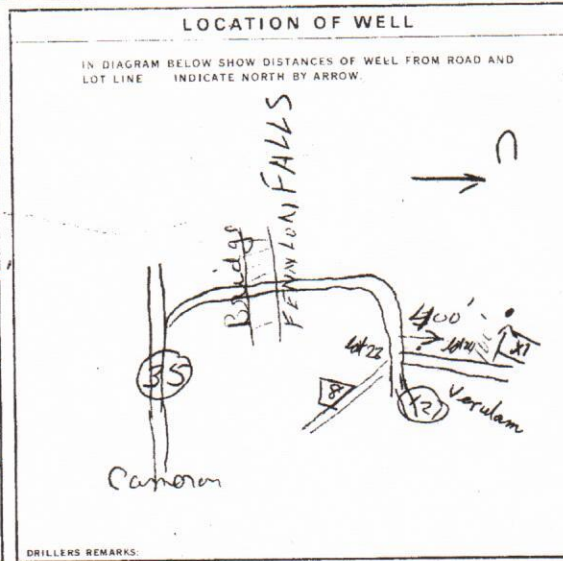

84 FINAL STATUS OF WELL: WATER SUPPLY

85-88 WATER USE: 01 DOMESTIC

89 METHOD OF DRILLING: 1 CABLE TOOL

CONTRACTOR: J.F. Henderson Ltd. LICENCE NUMBER: 2518

ADDRESS: 75 Durham St W. Lindsay

NAME OF DRILLER OR BORER: John Schub LICENCE NUMBER: _____

SIGNATURE OF CONTRACTOR: J. Schub SUBMISSION DATE: _____

OFFICE USE ONLY

DATA SOURCE: 1 CONTRACTOR: 2518 DATE RECEIVED: 140278

DATE OF INSPECTION: _____ INSPECTOR: _____

REMARKS: _____

P May 25/78

WI

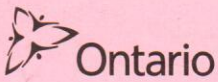

Measurements recorded in: Metric Imperial

A159093

Page ___ of ___

Well Owner's Information

First Name: Randy Puddister & Brenda Carroll; Last Name / Organization: Brenda Carroll; E-mail Address: ; Municipality: Fenelon Falls; Province: Ontario; Postal Code: K0M 1N0

Well Location

Address of Well Location: 33 Northline Rd; Township: Fenelon; Lot: 24; Concession: 10; County/District/Municipality: City of Kawartha Lakes; Province: Ontario; UTM Coordinates: NAD 83 17 680957 4935014

Overburden and Bedrock Materials/Abandonment Sealing Record

Table with 5 columns: General Colour, Most Common Material, Other Materials, General Description, Depth (m/ft). Includes handwritten notes: 'Well Upgrade Add 7ft of 6 1/2" of Casing Now has 2ft of stick up' and '*Well measures 55ft in depth*'.

Annular Space table with columns: Depth Set at (m/ft) From/To, Type of Sealant Used (Material and Type), Volume Placed (m³/ft³). Includes entries for Holeplug Screenings and Native Soil.

Method of Construction and Well Use checkboxes. Includes options like Cable Tool, Rotary, Boring, Air percussion, Diamond, Jetting, Driving, Digging, Public, Commercial, Domestic, Livestock, Irrigation, Industrial, etc.

Construction Record - Casing and Status of Well. Casing table includes Inside Diameter, Open Hole OR Material, Wall Thickness, Depth. Status of Well includes Water Supply, Replacement Well, Test Hole, Recharge Well, Dewatering Well, etc.

Construction Record - Screen table with columns: Outside Diameter, Material, Slot No., Depth (m/ft) From/To.

Water Details and Hole Diameter checkboxes. Includes options for Fresh/Untested water and Hole Diameter (Depth and Diameter).

Results of Well Yield Testing table. Columns: After test of well yield, water was; Draw Down (Time, Water Level); Recovery (Time, Water Level). Includes data for pumping rate, duration, and final water level.

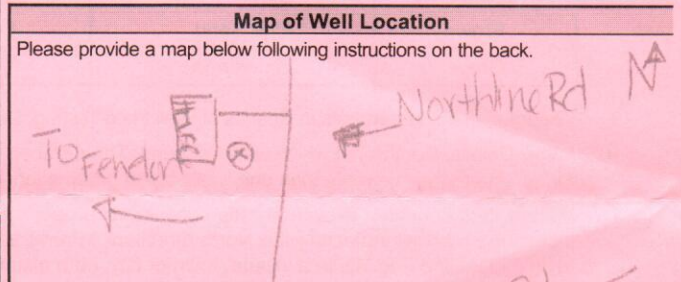

| Method of Construction | | Well Use | | |
|--|----------------------------------|---|---|-------------------------------------|
| <input type="checkbox"/> Cable Tool | <input type="checkbox"/> Diamond | <input type="checkbox"/> Public | <input type="checkbox"/> Commercial | <input type="checkbox"/> Not used |
| <input type="checkbox"/> Rotary (Conventional) | <input type="checkbox"/> Jetting | <input type="checkbox"/> Domestic | <input type="checkbox"/> Municipal | <input type="checkbox"/> Dewatering |
| <input type="checkbox"/> Rotary (Reverse) | <input type="checkbox"/> Driving | <input type="checkbox"/> Livestock | <input type="checkbox"/> Test Hole | <input type="checkbox"/> Monitoring |
| <input type="checkbox"/> Boring | <input type="checkbox"/> Digging | <input type="checkbox"/> Irrigation | <input type="checkbox"/> Cooling & Air Conditioning | |
| <input type="checkbox"/> Air percussion | | <input type="checkbox"/> Industrial | | |
| <input type="checkbox"/> Other, specify _____ | | <input type="checkbox"/> Other, specify _____ | | |

| Construction Record - Casing | | | | Status of Well | |
|------------------------------|--|------------------------|--------------|----------------|---|
| Inside Diameter (cm/in) | Open Hole OR Material (Galvanized, Fibreglass, Concrete, Plastic, Steel) | Wall Thickness (cm/in) | Depth (m/ft) | | <input type="checkbox"/> Water Supply <input type="checkbox"/> Replacement Well <input type="checkbox"/> Test Hole <input type="checkbox"/> Recharge Well <input type="checkbox"/> Dewatering Well <input type="checkbox"/> Observation and/or Monitoring Hole <input type="checkbox"/> Alteration (Construction) <input type="checkbox"/> Abandoned, Insufficient Supply <input type="checkbox"/> Abandoned, Poor Water Quality <input type="checkbox"/> Abandoned, other, specify _____ <input type="checkbox"/> Other, specify _____ |
| | | | From | To | |
| | | | | | |
| | | | | | |
| | | | | | |

| Construction Record - Screen | | | | Status of Well | |
|------------------------------|---------------------------------------|----------|--------------|----------------|---|
| Outside Diameter (cm/in) | Material (Plastic, Galvanized, Steel) | Slot No. | Depth (m/ft) | | <input type="checkbox"/> Abandoned, Poor Water Quality <input type="checkbox"/> Abandoned, other, specify _____ <input type="checkbox"/> Other, specify _____ |
| | | | From | To | |
| | | | | | |
| | | | | | |

| Water Details | | Hole Diameter | |
|--|---|-------------------|----|
| Water found at Depth (m/ft) <input type="checkbox"/> Gas <input type="checkbox"/> Other, specify _____ | Kind of Water: <input type="checkbox"/> Fresh <input type="checkbox"/> Untested | Depth (m/ft) From | To |
| | | | |
| Water found at Depth (m/ft) <input type="checkbox"/> Gas <input type="checkbox"/> Other, specify _____ | Kind of Water: <input type="checkbox"/> Fresh <input type="checkbox"/> Untested | | |
| | | | |
| Water found at Depth (m/ft) <input type="checkbox"/> Gas <input type="checkbox"/> Other, specify _____ | Kind of Water: <input type="checkbox"/> Fresh <input type="checkbox"/> Untested | | |
| | | | |

| Well Contractor and Well Technician Information | | | |
|--|--|---|--|
| Business Name of Well Contractor G. Hart & Sons Well Drilling Ltd | | Well Contractor's Licence No. 2 6 6 2 | |
| Business Address (Street Number/Name) P.O. Box 950 Fenelon Falls | | Municipality | |
| Province Ont | Postal Code K0M 1N0 | Business E-mail Address ghart ghart.ca | |
| Bus. Telephone No. (inc. area code) 705 377 3331 | Name of Well Technician (Last Name, First Name) Leeder, Aaron | | |
| Well Technician's Licence No. | Signature of Technician and/or Contractor | Date Submitted | |

| | | |
|--|----|----|
| Pump intake set at (m/ft) | 2 | 2 |
| Pumping rate (l/min / GPM) | 3 | 3 |
| Duration of pumping hrs + min | 4 | 4 |
| Final water level end of pumping (m/ft) | 5 | 5 |
| If flowing give rate (l/min / GPM) | 10 | 10 |
| Recommended pump depth (m/ft) | 15 | 15 |
| Recommended pump rate (l/min / GPM) | 20 | 20 |
| Well production (l/min / GPM) | 25 | 25 |
| Disinfected? <input type="checkbox"/> Yes <input type="checkbox"/> No | 30 | 30 |
| | 40 | 40 |
| | 50 | 50 |
| | 60 | 60 |

| Map of Well Location |
|---|
| Please provide a map below following instructions on the back. |
| <p>The map shows a well location marked with a circled 'X'. It is situated near Fenelon Falls, with Northline Rd to the north and Bobcaygeon to the south. A road labeled 'CH/PA/CD' is also shown.</p> |

| | | |
|---|---|--|
| Comments: | | |
| Well owner's information package delivered <input type="checkbox"/> Yes <input type="checkbox"/> No | Date Package Delivered Y Y Y Y M M D D Date Work Completed 2014 10 08 Y Y Y Y M M D D | Ministry Use Only Audit No. Z182915 Received |